

Connections for HAEHNE Sensors

Electrical Connections

Depending on the sensor type various versions of electrical connections are offered. The corresponding variants are listed in the respective product descriptions.

The standard cable length for all options is 5 meters. Cable lengths up to 20 meters are available on request.



S1, S2, N1, N2

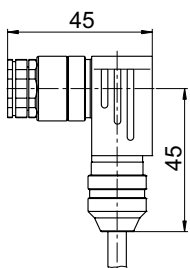

Variant S1
Plug connection
right-angled, M12, metal

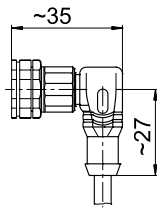

Variant S2
Plug connection
right-angled, M12, moulded

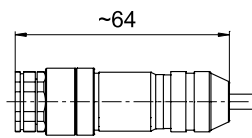

Variant N1
Plug connection,
straight, M12, metal

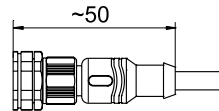

Variant N2
Plug connection
straight, M12, moulded

Wire assignment

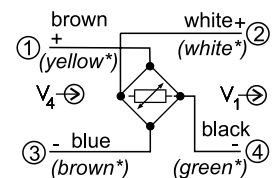

V_4 : Supply voltage
 V_1 : Signal voltage

*Alternative
color coding

S, S3, S4, N3

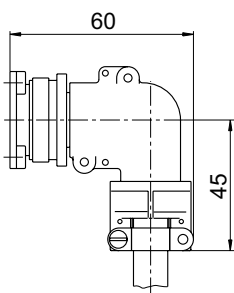

Variant S
Plug connection
right-angled, MIL

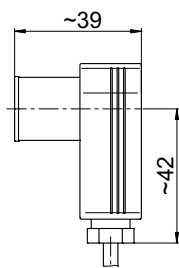

Variant S4
Plug connection
right-angled, C091

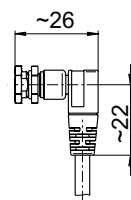

Variant S3
Plug connection
right-angled, M8,
moulded

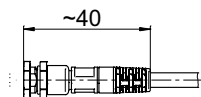

Variant N3
Plug connection
straight, M8,
moulded

Wire assignment

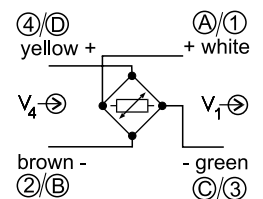

V_4 : Supply voltage
 V_1 : Signal voltage

T

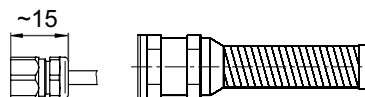
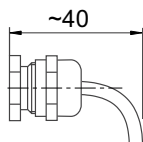

Cable gland, design
dependent on sensor type.

Wire assignment

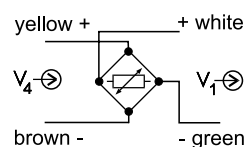

V_4 : Supply voltage
 V_1 : Signal voltage

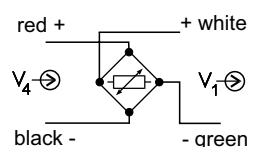

Alternative color coding
Teflon cable \varnothing 3,1